

12,000 Lumens Flood.
Waterproof to 100m/330ft

Features

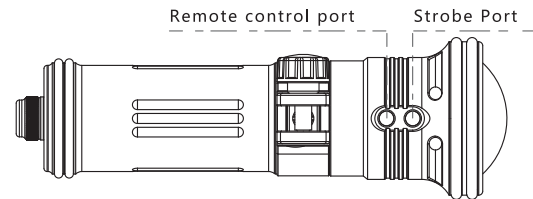
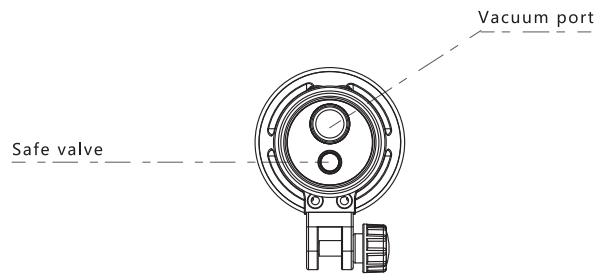
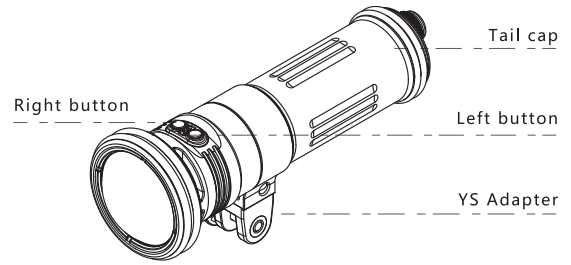

01

Standard Accessories

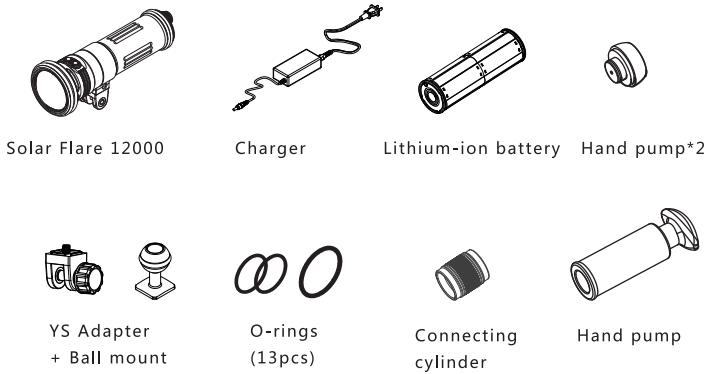

To install the battery

1. Turn the tail cap counter-clockwise to open;
2. Put the Lithium-ion battery into the battery compartment, the battery compartment is located in the body (diagram below).
3. Turn the tail cap clockwise to close the battery compartment (i.e. reattach the tail to the light head).

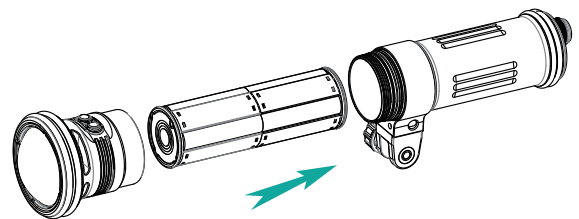

Specification

Brightness	12000 lumens flood
Depth Rating	100m / 330ft
Beam Angle	120 degree on land 120 underwater
Color Temperature	5600K, Ra=90
Power Level	100% / 80% / 60% / 40% / 20% / 300 lumens
Button	Dual push button with battery level meter
Burn Time	Approx. 60 minutes (100% flood)
Battery	8 * 18650 wrapped to single cell (6800mAh 14.4V)
Charge Time	4 hours from zero
Dimensions	73 (D) * 234 (L) mm
Weight	1060g (on land) 530g (underwater)

Operating the light

Turn ON:

1. Press and hold the left and right buttons down at the same time for one second.
2. Press and immediately release the left button. When the light turns on it will be at 100% brightness.

Turn OFF:

Press and hold the left and right buttons down at the same time for two seconds.

Adjusting the brightness:

To increase the brightness: Press and immediately release the **right** button.

To decrease the brightness: Press and immediately left the **left** button.

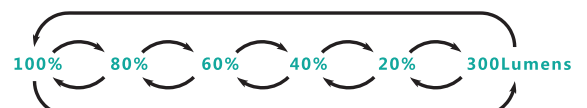

Strobe mode

When the light is on, Press the right button and hold it down for one second the Strobe mode will be ON/OFF.

Press and immediately release the left button.



Press and immediately release the right button.

SOS mode:

Turn ON/OFF: Press and immediately release the left and right buttons at the same time when the light is on.

Press and immediately release the right button.



Remote control

The remote control is an optional accessory.

Using the vacuum system

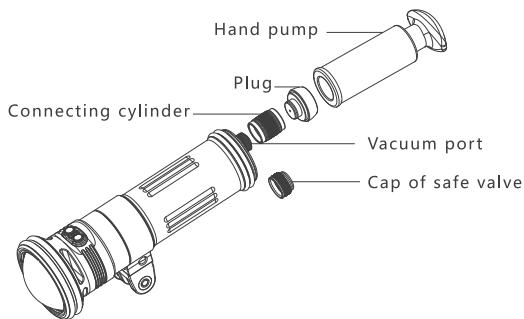

04

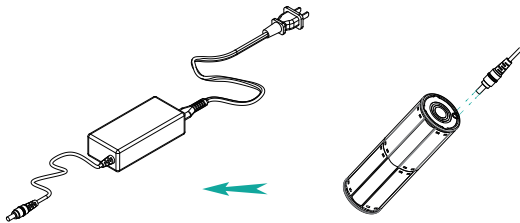

Thermal protection

If the inner temperature of the video light becomes too high the video light will automatically decrease the brightness of the light.

Battery Level Indicator

There are four colors to indicate the amount of power remaining in the battery:

Blue: fully charged

Green: ~50% charged

Red: battery is low. When the battery is empty the indicator light

Flashing Red: battery is empty, light will power-off.

When the battery level is low the video light will automatically adjust the brightness (lower) to conserve power

General Maintenance

There are two O-rings in the tail cap. Use silicone to keep the O-rings well lubricated. It is important to lubricate the o-rings if the video light has not been used in a long time or if the O-ring is hard. If the O-ring is damaged, broken or deformed it should be replaced with the a new O-ring. Two spare O-rings are included with your video light.

NOTE: Do not use a sharp tool to remove the O-ring.

06

1. Open the Cap of safe valve and Attach the connecting cylinder to the Vacuum port.

2. Insert the plug into the Connecting cylinder and attach the hand pump to the Plug to pumping.

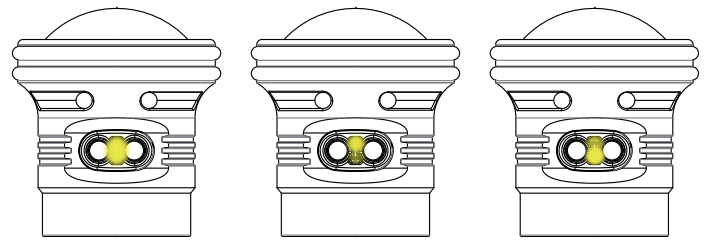

- Before pumping (air leakage or no pumping), the light is yellow
- The yellow light flash rapidly when pumping
- The yellow light flash slowly when pumping is done.

****Be sure to cover and tighten the exhaust valve knob after pumping**

Sleep Mode:

When the light is on, Press the left button and hold it down for one second the Sleep mode will be ON.

When the light is on, Press the left button and hold it down for one second the Sleep mode will be OFF.

The indicator will be on , but the light is OFF

To Charge the Battery

1. Insert the DC charger plug into the battery (as shown in the diagram below).
2. Plug the charger into the wall outlet. When the battery starts to charge the indicator light on the charger will be red.
3. When the battery is fully charged the indicator light on the charger will turn green.

05

Warnings

1. Do not open the tail cap when the video light is in the water.
2. Do not shine the light directly into your eyes or another person's eyes.
3. Do not touch the battery and charger with wet hands.
4. Use only the manufacturer's battery and charger with this system.
5. If the video light will not be used for a long period of time the battery should be removed.

Failure to comply with these warnings may result in damage to the video light and will nullify the warranty.

Warranty

Weefine provides a warranty against manufacturer defects for 1 year starting from the date of purchase. Manufacturer defects occurring within 15 days of the date of purchase will result in an exchange of product at the vendor. All other manufacturer defects occurring within 1 year of the purchase will be repaired at no cost. Proof of purchase is required for warranty support. The warranty does not cover failures or defects resulting from misuse (e.g.: modification; damage), natural disasters, or battery issues, including incorrect battery installation.

Trouble Shooting

Before returning the video light to the vendor, please try the following:

Symptom	Solution
The video light does not work	<p>Check the battery to make sure it is inserted so that the negative end of the battery is aligned with the negative terminal in the battery compartment and the positive end of the battery is aligned with the positive terminal of the battery compartment.</p> <p><i>Note: The battery compartment is in the tail cap</i></p> <p>Ensure the battery is charged</p> <p>Ensure the tail cap is attached tightly to the light head</p>
Water is leaking into the light	<p>Check the O-rings in the tail cap to make sure that they are not broken and that nothing is preventing a proper seal</p>
Indicator light is green when the battery begins charging	<p>Check the battery to make sure that it is inserted into the charger in the correct direction and that the battery has good contact with the charging terminal.</p>

07